

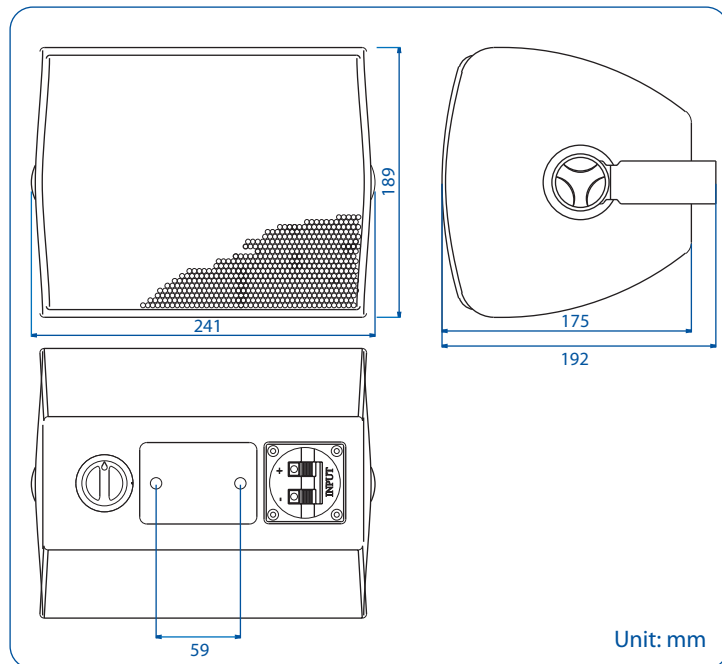

# CAL-5 Series Pro Audio Cabinet Loudspeaker



Unit: mm

- ☒ 100 Hours Life Tested
- ☒ CE Certified (EMC & LVD)
- ☐ IP Rated
- ☐ Rustproof
- ☒ UL94V0
- ☐ BS 5839 Part 8
- ☒ EASE Data
- ☒ RoHS Compliance
- ☐ UV Protected
- ☒ Withstanding/Insulation Tested

- Designed for the pro audio and commercial market.
- Designed utilizing CES Audio's anechoic test facilities with state of the art digital system analysis for accurate cabinet specification.
- Attractive trapezoid cabinet design for improved directivity and versatile mounting.
- Very high quality 2-way speaker system with 5" polypropylene bass / mid cone & 10-ounce magnet + mylar laminate dome tweeter.
- Powerful 8Ω operation.
- 30 watt transformer version with multi tapplings down to 3.75W (100V) & 1.9W (70V) - via rear-mount selector control.
- U mount bracket included as a standard accessory.
- Durable Nylon / Fibre multi bracket optional (broken tested up to 45.4 kgs / 100 lbs).  
(B8-10-0091 Multi bracket-Black & B8-19-0091 Multi bracket-White - See accessory page)
- Finished in black (RAL 9005) or brilliant white (RAL 9016).

Model No.	CAL-5300	CAL-5300W	CAL-5608	CAL-5608W
Rated Power (rms)	30W		60W	
Impedance	333Ω, 667Ω, 1.30kΩ & 2.60kΩ		8Ω	
Power Taps @ 100V	30W, 15W, 7.5W, 3.75W & 8Ω		N. A.	
Power Taps @ 70V	15W, 7.5W, 3.75W,1.9W & 8Ω			
SPL (1W / 1M)	89 dB			
Max. SPL (Rated W / 1M)	104 dB		107 dB	
Frequency Range (-10dB)	75 Hz ~ 25K Hz			
Dispersion 1K Hz / 4K Hz	190° / 125°			
Ambient Temperature	-20°C ~ +60°C			
Power Selection	Selecting Switch		N. A.	
Termination	Push Terminal			
Material	Housing: High impact polystyrene, Grille: Steel.			
Colour / Finish	Black (RAL 9005)	White (RAL 9016)	Black (RAL 9005)	White (RAL 9016)
Dimensions	241 (9.49) W X 189 (7.44) H X 175 (6.89) D mm. (in.)			
Net Weight (ea)	2.66 kgs (5.86 lbs.)		2.10 kgs (4.63 lbs.)	
Mounting	U Type Steel Bracket			